

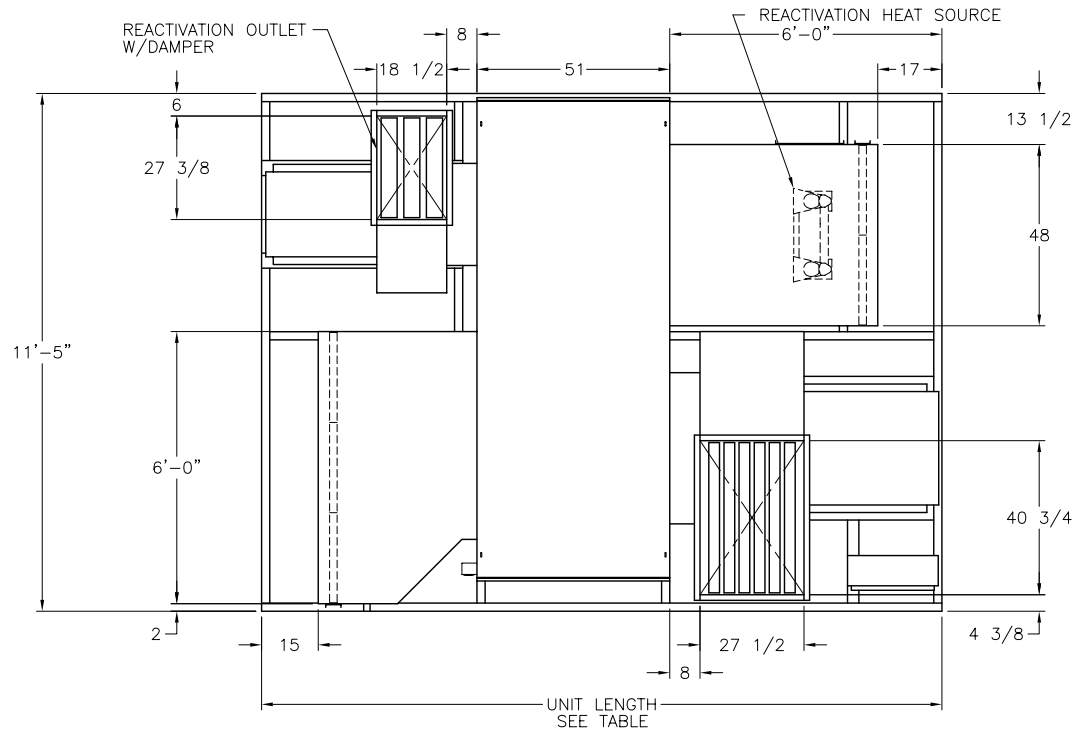

BRY-AIR, INC.
 ROUTE 37 WEST
 SUNBURY, OHIO 43074
 TEL (740) 965-2974
 FAX (740) 965-5470
 E-MAIL: bryair1@bry-air.com

VFB-300 DEHUMIDIFIER



SPECIFICATIONS	VFB-300
Process SCFM	30,000
Reactivation SCFM	10,000
Process Ext. Static (inches w.c.)	1.5
Reactivation Ext. Static (inches w.c.)	0.75
Process motor H.P.	40
Reactivation motor H.P.	15
Bed motor H.P.	1/12
Reactivation Heat Req'd - MBH	2160
Control Load - KVA @ 120 V	0.75
Approximate weight - lbs.	8500

UNIT LENGTH TABLE

React. Heat Source	Construction			
	Std. Indoor 30% Eff. Inlet Filters	Indoor High Eff. Filters	Outdoor 30% Eff. Inlet Filters	Outdoor High Eff. Filters
Electric	15'-0"	15'-0"	15'-0"	15'-0"
Gas	15'-0"	15'-0"	15'-0"	15'-0"
Steam	17'-0"	18'-0"	17'-4"	18'-4"

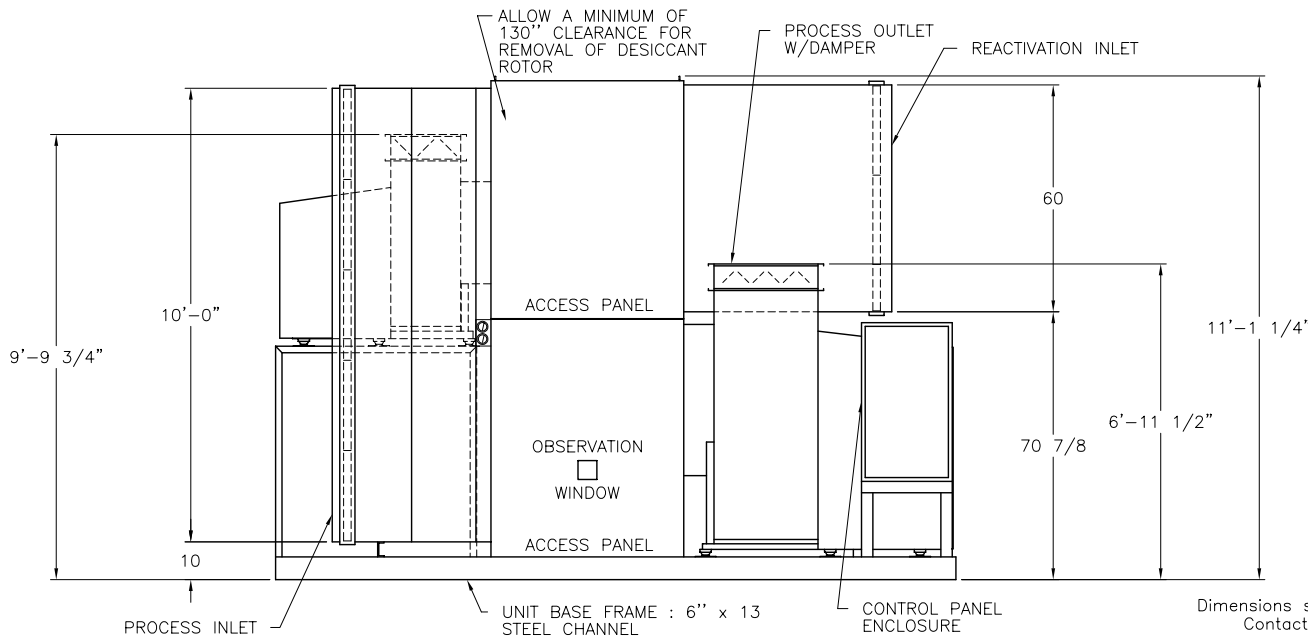

NOTES:

- For outdoor construction the reactivation fan is rotated to a horizontal discharge and a rain hood is added.
- Supply voltage must be specified.
- Electrical components are mounted in a drip proof enclosure.
- Unless otherwise noted, provide 25" clearance around the entire unit and 40" clearance in front of the control panel enclosure.
- All dimensions are in inches and are subject to change without notice.
- Specifications subject to change without notice.

This is not a certified drawing.
 Dimensions shown are for standard gas indoor construction.
 Contact factory for certified dimensional drawings.

BA-794-2
 11/21/03