

BRY-AIR, INC.
 ROUTE 37 WEST
 SUNBURY, OHIO 43074
 TEL (740) 965-2974
 FAX (740) 965-5470
 E-MAIL: bryair1@bry-air.com

VFB-6 DEHUMIDIFIER

| SPECIFICATIONS | VFB-6 |
|--|-------|
| Process SCFM | 600 |
| Reactivation SCFM | 200 |
| Process Ext. Static (inches w.c.) | 1.5 |
| Reactivation Ext. Static (inches w.c.) | 0.75 |
| Process motor H.P. | 1 1/2 |
| Reactivation motor H.P. | 3/4 |
| Bed motor H.P. | 1/20 |
| Reactivation Heat Req'd - MBH | 43.2 |
| Control Load - KVA @ 120 V | 1.5 |
| Approximate weight - lbs. | 480 |

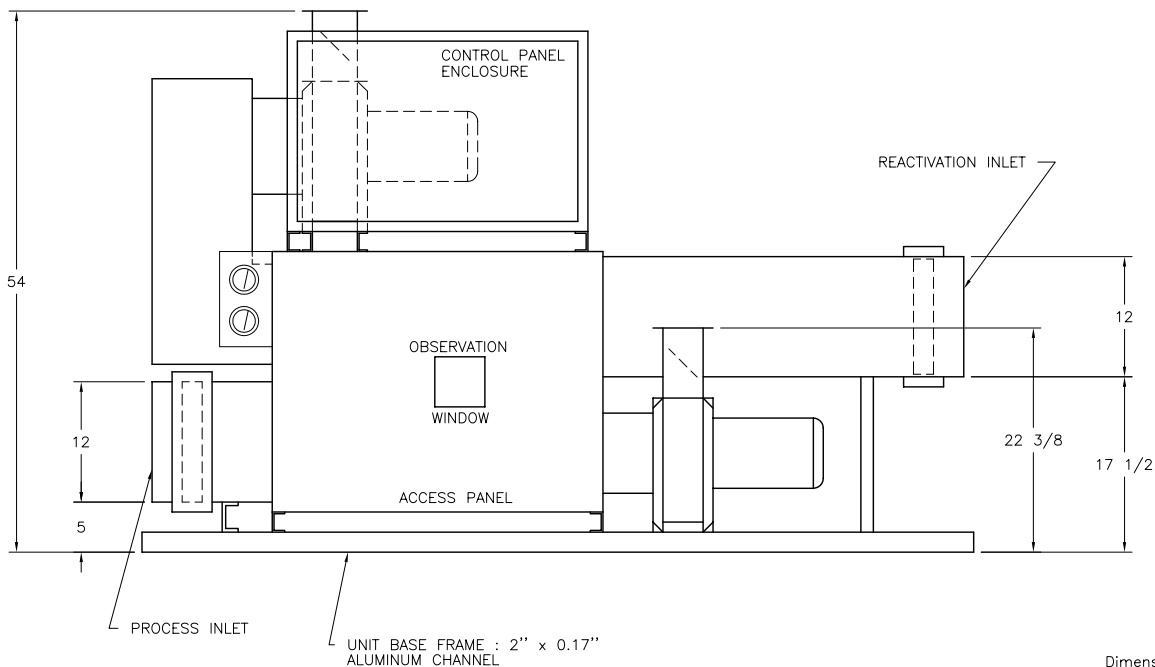

UNIT LENGTH TABLE

| React. Heat Source | Construction | | | |
|--------------------|------------------------------------|--------------------------|--------------------------------|---------------------------|
| | Std. Indoor 30% Eff. Inlet Filters | Indoor High Eff. Filters | Outdoor 30% Eff. Inlet Filters | Outdoor High Eff. Filters |
| Electric | 6'-11" | 7'-11" | 7'-3" | 8'-7" |
| Gas | 8'-6" | 9'-6" | 8'-10" | 9'-10" |
| Steam | 7'-6" | 8'-6" | 7'-10" | 8'-10" |

NOTES:

- For outdoor construction the reactivation fan is rotated to a horizontal discharge and a rain hood is added.
- Supply voltage must be specified.
- Electrical components are mounted in a drip proof enclosure.
- Unless otherwise noted, provide 25" clearance around entire unit and 40" in front of the control panel enclosure.
- All dimensions are in inches and are subject to change without notice.
- Specifications subject to change without notice.

This is not a certified drawing.
 Dimensions shown are for standard electric indoor construction.
 Contact factory for certified dimensional drawings.

BA-783-2
 11/21/03